

PLAN SHOWING THE PROPOSED CONSTRUCTION OF RESIDENTIAL BUILDING IN S.No 149 PART & 151 PART  
 VILLAGENO. 81, MOGAPPAR VILLAGE, SAIDAPET TALUK, CHENGALPATTU DISTRICT, AMBATTUR TOWNSHIP

Planning Permit No. A/351/90

**APPROVED**  
 SUBJECT TO THE CONDITIONS IN  
 THIS OFFICE LETTER.  
 No. A/1666/90 Date 28/3/90  
 FOR MEMBER SECRETARY  
 MADRAS METROPOLITAN  
 DEVELOPMENT AUTHORITY  
 MADRAS - 600 008.



**SPECIFICATIONS**  
 FOUNDATION BED CONCRETE IN 1:4:8 MIX USING 40mm  
 H-B-G METAL. P.C.C 1:2:4 USING 20mm B-G METAL.  
 BRICK WORK IN CM 1:5 FOR FOUNDATION AND SUPER  
 STRUCTURE R.C.C 1:2:4 FOR PLINTH BEAM LINTEL CUM  
 SUNSHADE AND ROOF SLAB. PLASTERING IN C.M 1:5 FOR  
 INSIDE AND OUTSIDE WALLS. CEILING SHALL BE PLASTER-  
 ED IN C.M 1:3. DOORS AND WINDOWS ARE IN TEAK WOOD.  
 FLOORING IN MOSAIC USING IN GREY CHIPS. ROOF SLAB  
 OVER WEATHERING COURSE TOP FINISHED WITH ONE  
 LAYER OF PRESSED TILES.

*D. 2.90* *22.1.90*

**JOINERY DETAILS**

D - DOOR	3'-3" X 7'-0"	100 X 2-14
D <sub>1</sub> - DOOR	3'-0" X 7'-0"	91 X 2-14
D <sub>2</sub> - DOOR	2'-6" X 7'-0"	76 X 2-14
W - WINDOW	4'-6" X 4'-6"	137 X 137
W <sub>1</sub> - WINDOW	4'-0" X 4'-6"	122 X 137
V - VENTILATOR	2'-6" X 2'-0"	76 X -61

**AREA DETAILS**

PLOT EXTENT:- 3600 SQ. FT (or) 334.57 SQ. M  
 PLINTH AREA : 727 SQ. FT (or) 67.57 M<sup>2</sup>  
 PLOT COVERAGE:- 20%

**SIG. OF OWNER**  
*P. Shanmugam*

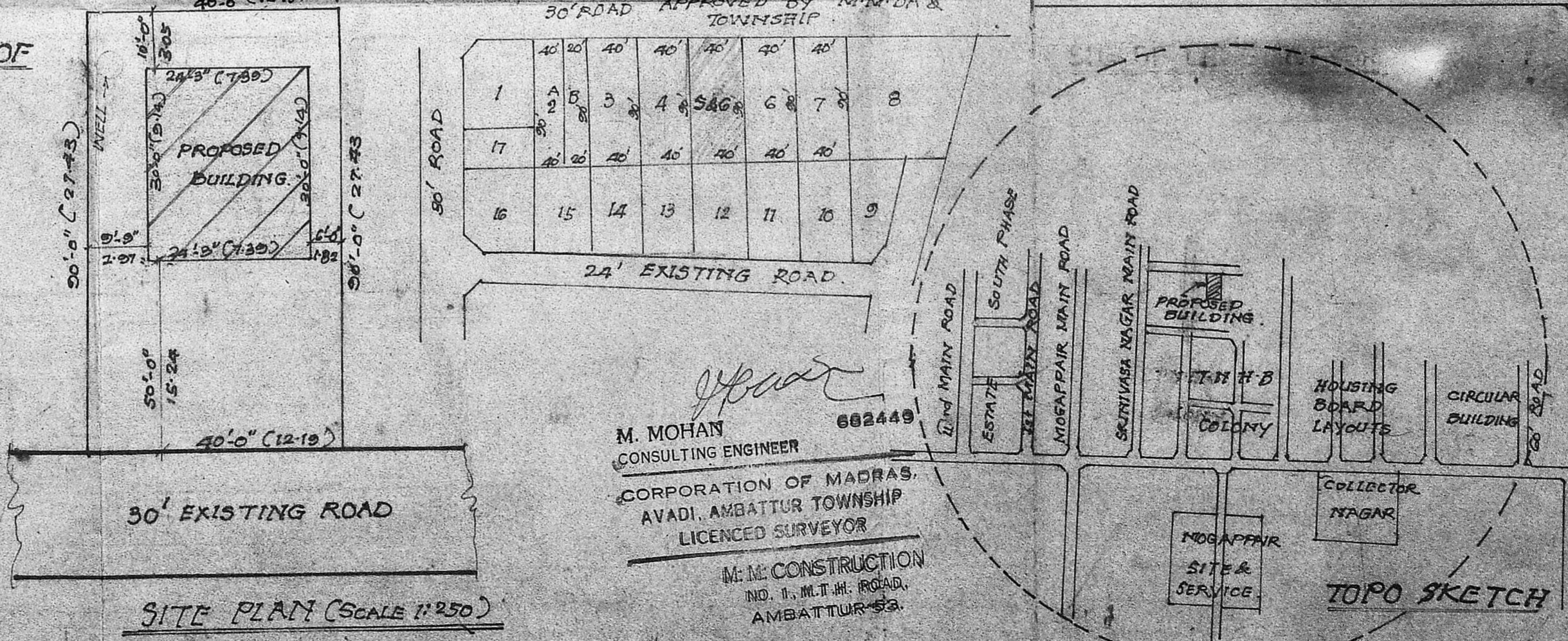
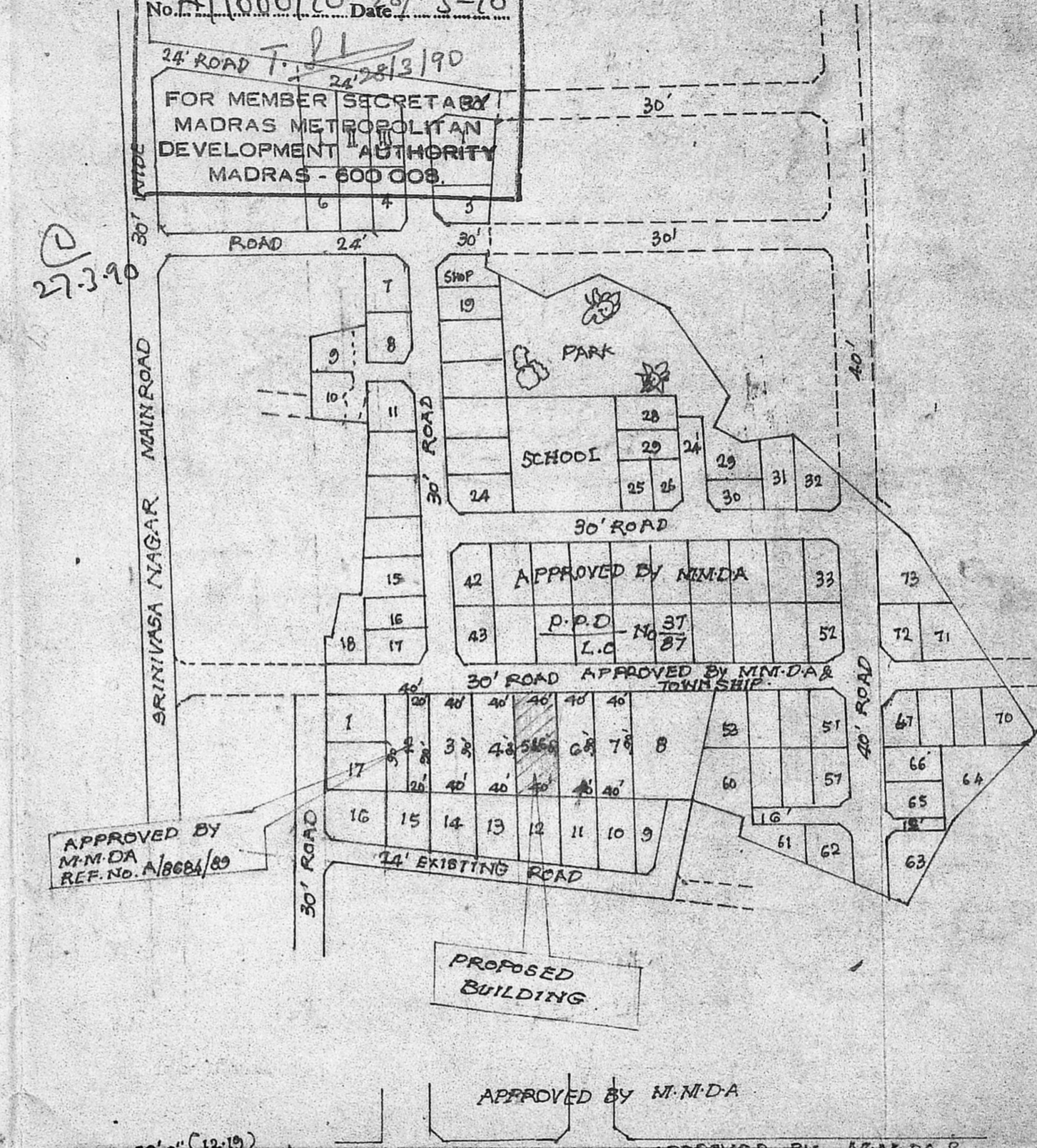
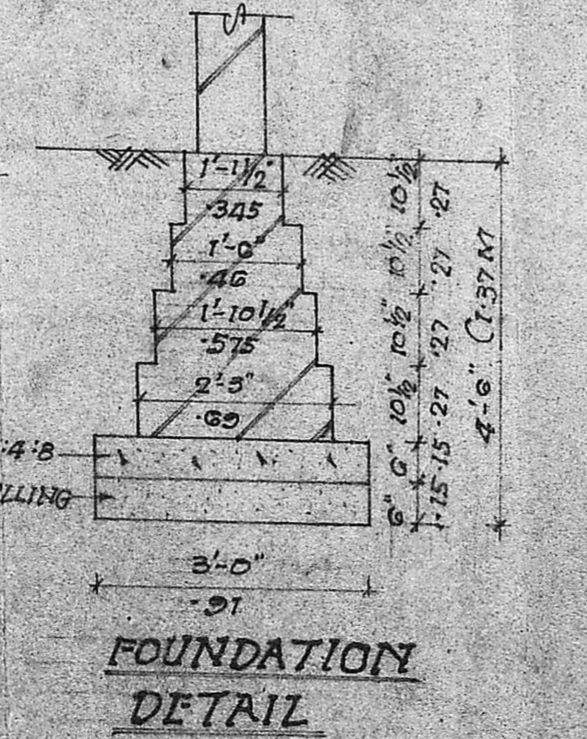
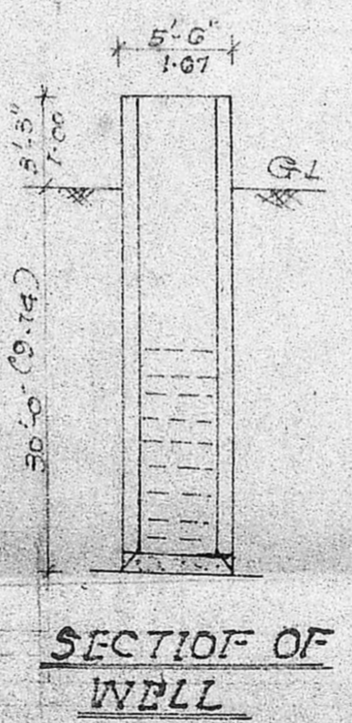
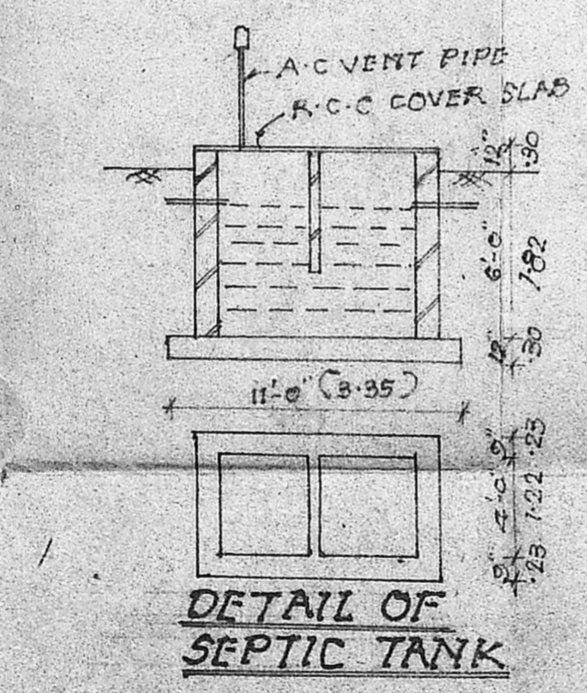
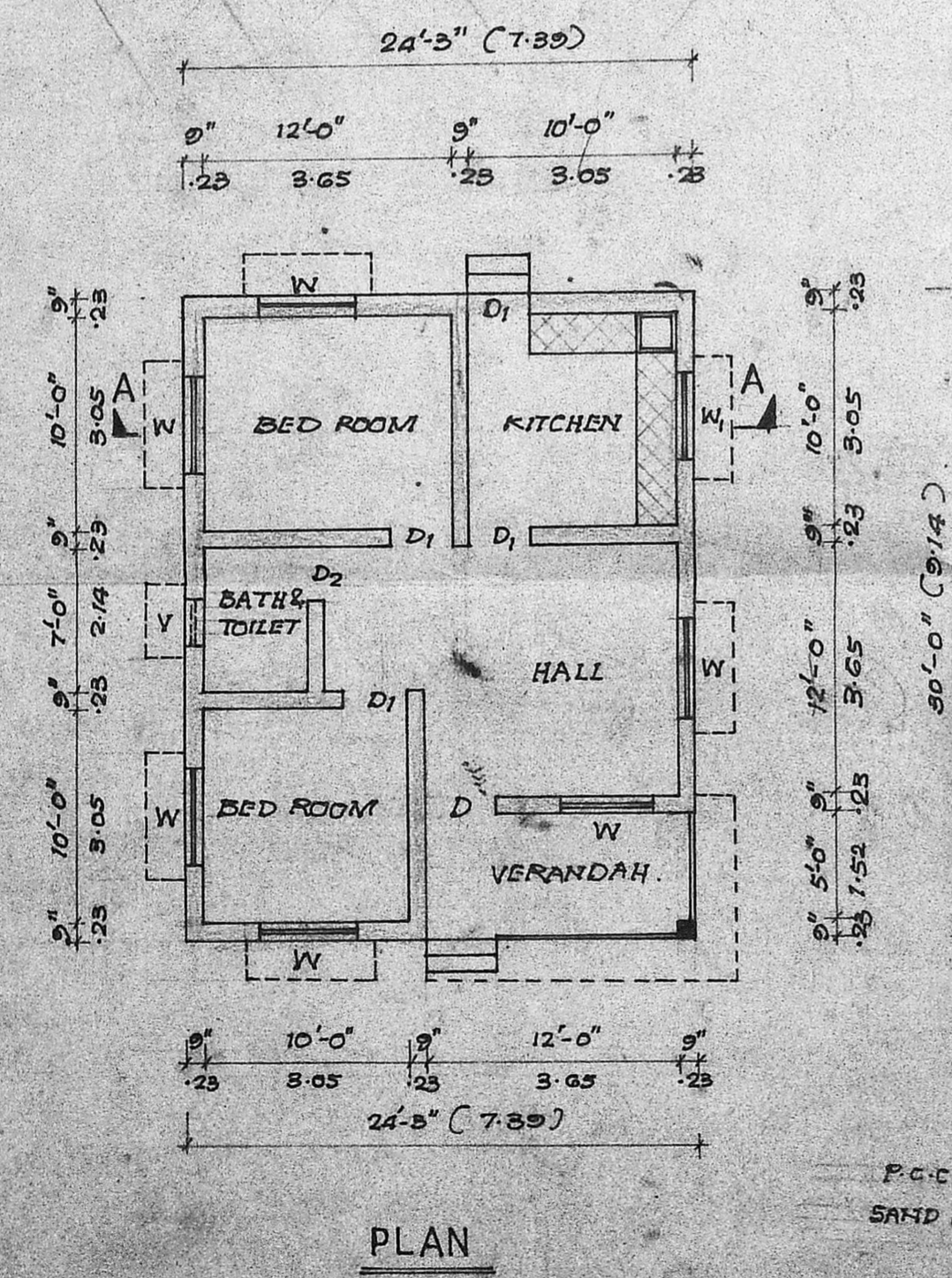
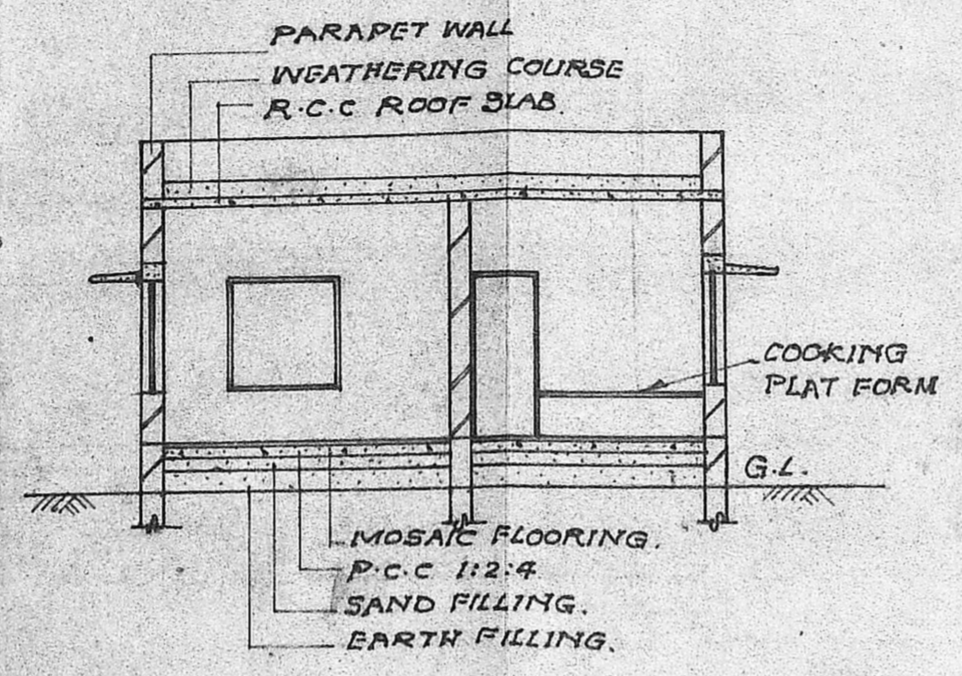
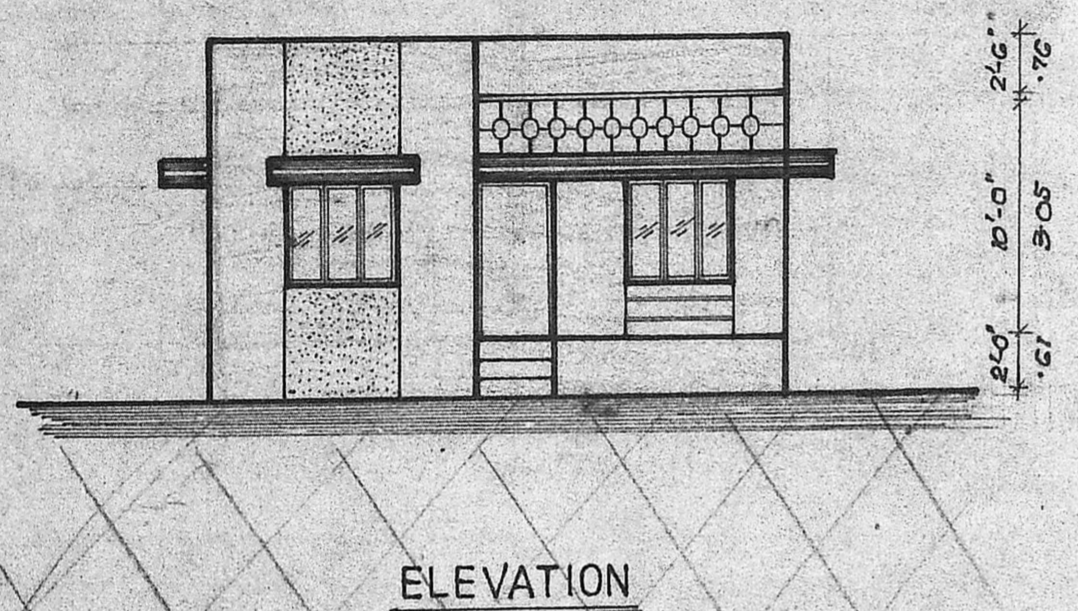

*M. Mohan*  
 M. MOHAN  
 CONSULTING ENGINEER  
 CORPORATION OF MADRAS,  
 AVADI, AMBATTUR TOWNSHIP  
 LICENCED SURVEYOR  
 M.M. CONSTRUCTION  
 NO. 11, M.T.H. ROAD,  
 AMBATTUR-52.

MOGAPPAR  
 SITE &  
 SERVICE.  
 COLLECTOR  
 NAGAR.  
 TOPO SKETCH